

2-pipe snow guard raising part

With the snow guard raising part, a 2-pipe snow guard can be raised to a 3-pipe snow guard. The snow guard raising part can be retrofitted to the Pisko snow guard system. The snow guard raising part can be used with all 2-pipe snow guard brackets in the Pisko product family.

INSTALLATION

The snow guard raising part is mounted to the snow guard bracket with two M8x16 mm hexagonal bolts and nuts (Figure 1). The snow guard pipe is pushed through the brackets and locked in place with a self drilling screw from the outermost brackets (Figure 2).

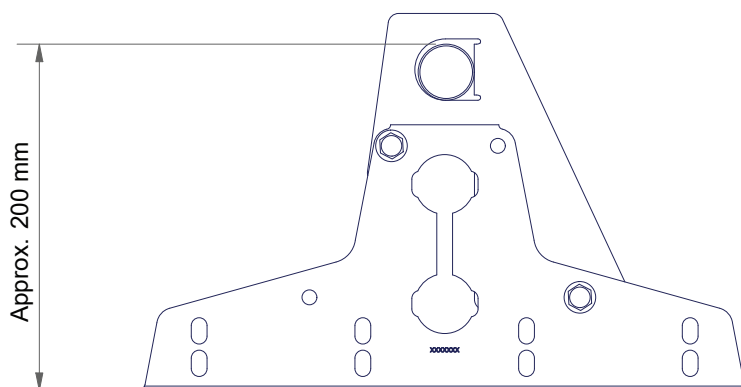
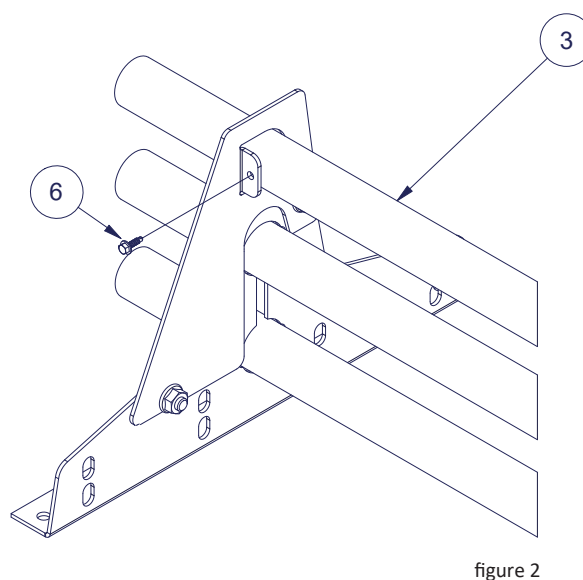
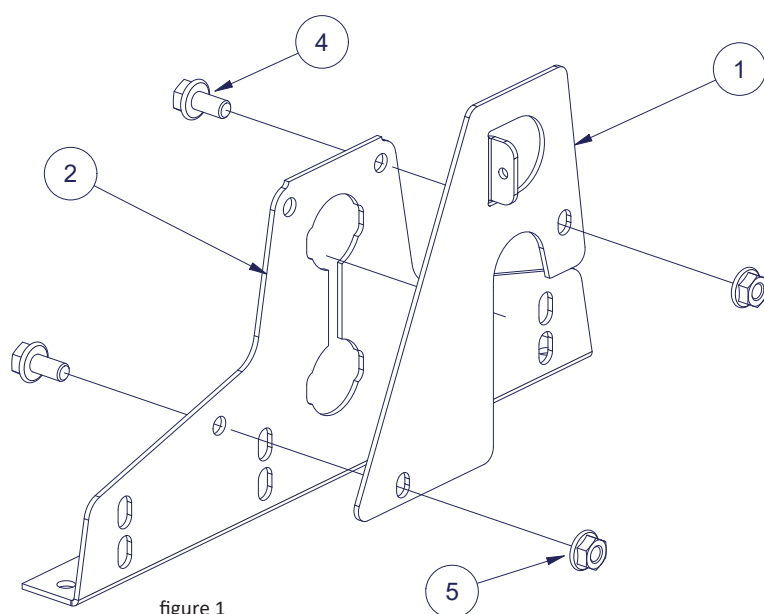

Part	Description
1	2-pipe snow guard raising part
2	Snow guard bracket
3	Snow guard pipe 32 mm
4	Hexagon screw M8 x 16*
5	Hexagon nut M8*
6	Pipe fixing screw, e.g. 4,8x25 self-tapping farmer screw or 4,8x19 self drilling screw

* HDG or equal corrosion protection

figure 3

MAINTENANCE

Pisko products are hard-wearing and safe to use, guaranteed by the ongoing quality control and development work by Piristeel Ltd, as well as correct installation of the products according to the manufacturer's instructions. To ensure the reliability and safety of the products, the property owner must carry out yearly inspection and maintenance procedures, and monitor that the snow load specified by the regulations is not exceeded.

- Check the tightness of joints, connections and attachments.
- Ensure any excessive snow load is cleared to minimize the strain on structures and attachment points (as necessary; there might be a need several times during the winter). Product durability in accordance with the certification certificate.
- Check the paintwork and zinc coating of the products; repair faults and touch up paintwork if necessary
- Replace or repair any damaged or faulty parts as soon as possible.