

Pisko snow rake for standing seam roof

ASSEMBLY

Multi-purpose standing seam brackets (1) are mounted on lock- / tinsmith seam with SG Tightening Clamps (2). Attach fastener and clamp to the seam.

Tightening torque of fastening bolt (3) is 18 N/m. Correct tightening torque will spread out the Tightening clamp a bit, in order to create a tight long-lasting connection.

NB! The bolt of Tightening clamp must always be against the fastener, NOT against the seam.

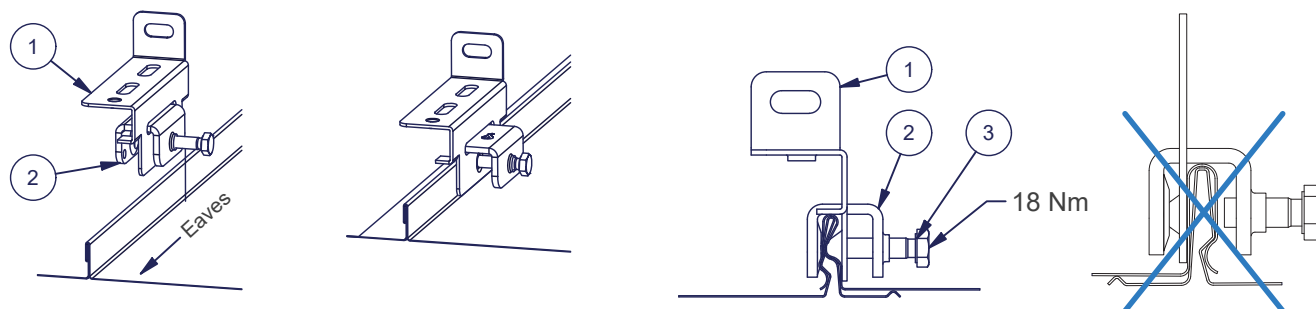

Install the Snow Rake (4) to the brackets (1) with M8x16 (5) flange bolt (can also be attached with M8x16 bolt and washer). Max. distance between the brackets is 1200 mm.

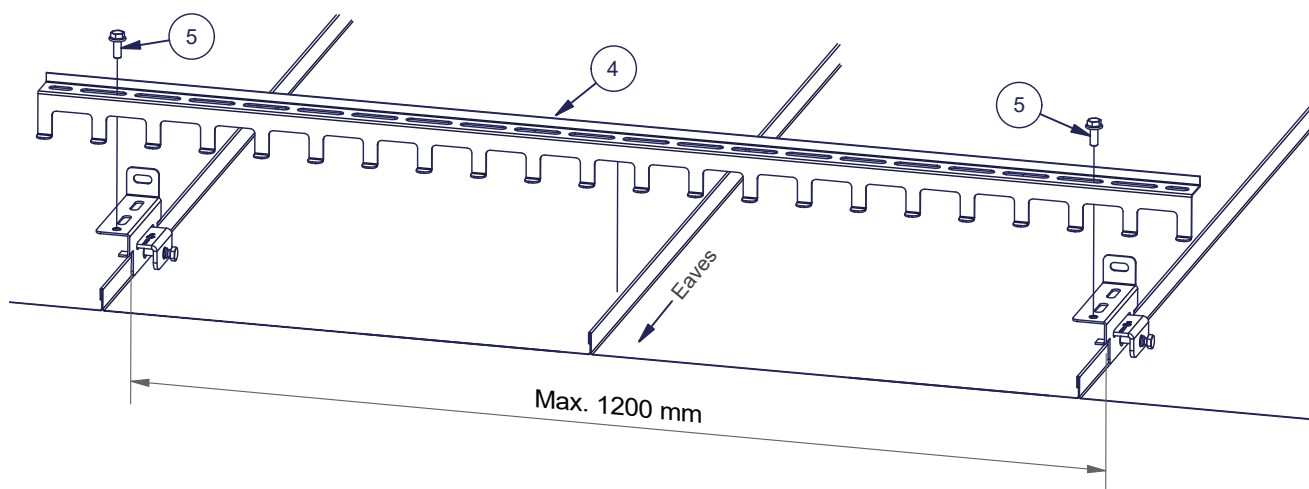

Install the Snow Rake on the roof so that the fingers do not overlap the seams. If this can't be avoided, bend the finger 90° upwards so that it doesn't touch the seam. Recommended height between the Snow rake and roof surface is 5 - 10 mm. Max. protrusion of the Snow Rake from the outermost bracket is 200 mm.

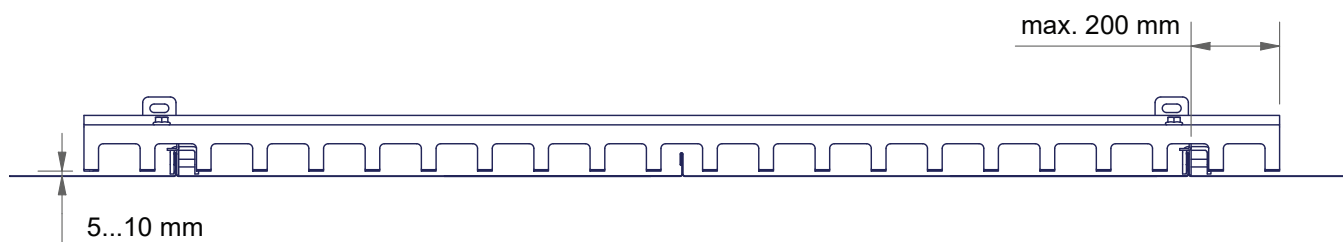

The extension of the snow rake shall be done by overlapping.

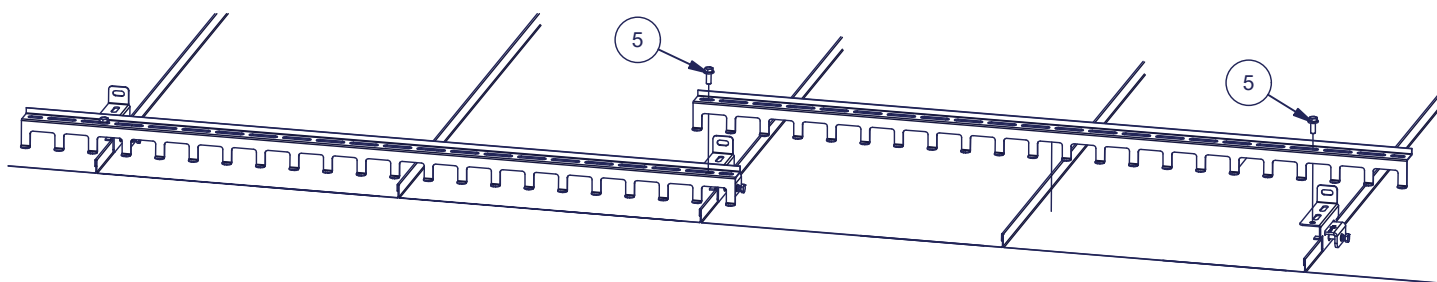

Part	Description
1	Multi-purpose standing seam bracket
2	SG Tightening clamp, Pisko Uniseam
3	Fastening bolt M8x30
4	Snow Rake
5	Flange bolt M8x16
6	Nut M8 HDG

Snow Rake can also be installed in the seam roof's snow fence or snow guard (pipes) by attaching it to the front of the bracket with a bolt and nut.

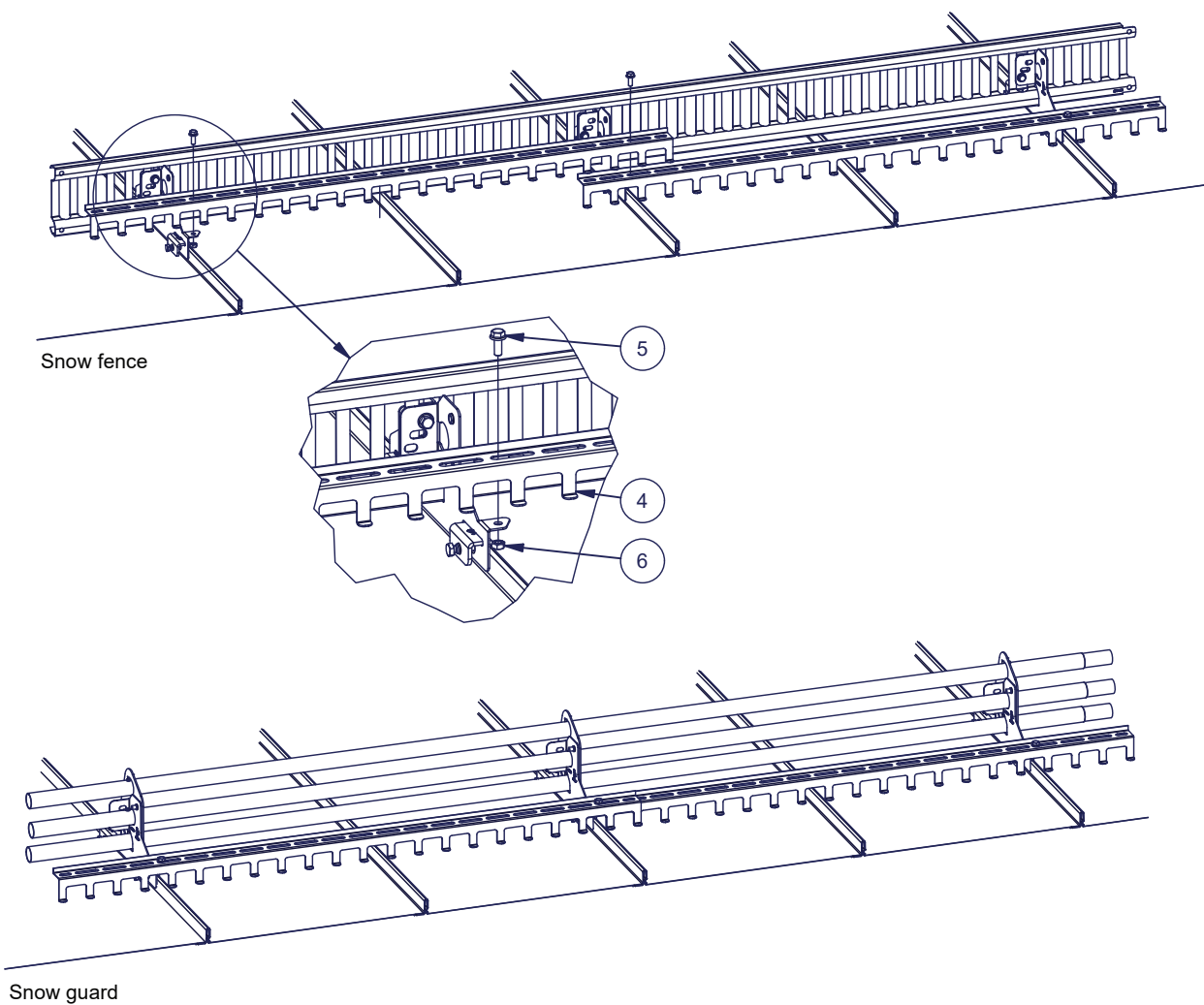

USE

The Pisko Snow Rake is intended as a complementary part of the actual snow guard that carries the main snow loads on the roof. The Snow Rake is installed as close as possible to the eaves. Its purpose is to prevent snow and ice flowing under the snow guard, especially from smooth seam roofs, and it is not intended to be the only snow guard on the roof.

MAINTENANCE

Pisko products are hard-wearing and safe to use, guaranteed by the ongoing quality control and development work by Piristeel Ltd, as well as correct installation of the products according to the manufacturer's instructions. To ensure the reliability and safety of the products, the property owner must carry out yearly inspection and maintenance procedures, and make sure that excessive snow load does not accumulate on the roof.

Yearly maintenance inspection checklist for Pisko snow guards:

- Check the tightness of joints, connections and attachments.
- Check fixings to the roof
- Take care to regularly clean the accumulated debris and dirt in the snow guard (such as leaves)
- Ensure any excessive snow load is cleared to minimize the strain on structures and attachment points of snow guard (as necessary; there might be a need several times during the winter). Product durability in accordance with the certification certificate.
- Check the paintwork and zinc coating of the products; repair faults and touch up paintwork if necessary
- Replace or repair any damaged or faulty parts as soon as possible.