

PISKO LADDER SAFETY CAGE

- Normal bows
- Wide bows

INSTALLATION WITH NORMAL BOWS

| Part | Description |
|------|---------------------------|
| 1 | Hexagon bolt M8x40, HDG |
| 2 | Hexagon nut M8, HDG |
| 3 | Hexagon bolt M8x16, HDG |
| 4 | Safety cage rim two-part |
| 5 | Rubber nut M8x50 |
| 6 | Washer 30mm |
| 7 | Vertical lath 1200 mm |
| 8 | Safety cage support left |
| 9 | Safety cage support right |
| 10 | Hexagon bolt M8x60, HDG |

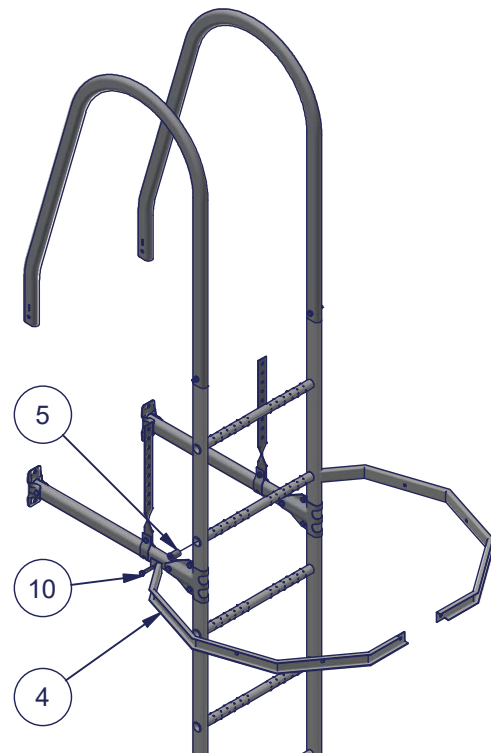

Before installing safety cage make sure that wall ladder bows are assembled as shown in the picture, in different direction compared to normal. Wall ladder is assembled otherwise like in wall ladder installation instruction.

Assemble pair of rims to wall ladders second highest rung. Push rubber nut inside the rung so that nut shoulder stays against the rung. Set M8x60 bolt through the rim to rubber nut and tighten up with impact wrench so that rubber nut sticks well inside the rung. Do not overtight or the bolt will pull the rubber nut out.

Note! Assembling can also be started from below. In this case it is important to carefully calculate right starting point. Rim pair is assembled to every fourth rung (every 1200 mm). Starting from second highest rung lowest rim pair level can be calculated depending on the height of the safety cage.

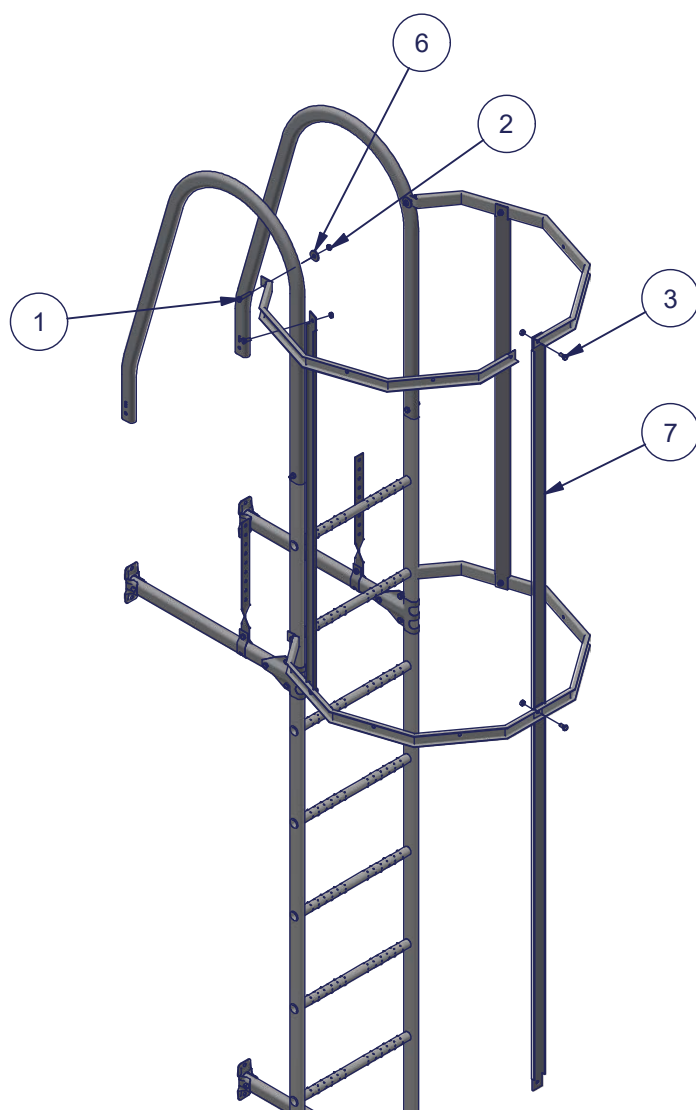

Fasten center line vertical lath pair through the rims with M8x16 bolt and nut.

Fasten top rim pair through vertical lath with M8x16 bolt and nut. After that fasten vertical lathes closest to the ladder between the rim pairs so that rims are installed parallel.

Check that rims are perpendicularly to the ladder. Drill holes through the bows and fasten top rims with M8x40 bolts. Assemble 30 mm washers with M8 nuts.

Install required number of rim pairs and centerline vertical laths every 1200 mm. Make sure, that every rim pair is fastened to wall ladder and to centerline vertical laths.

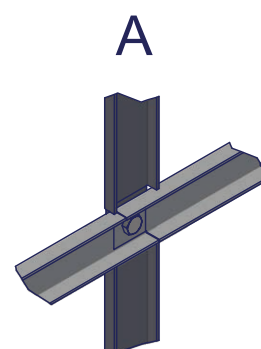

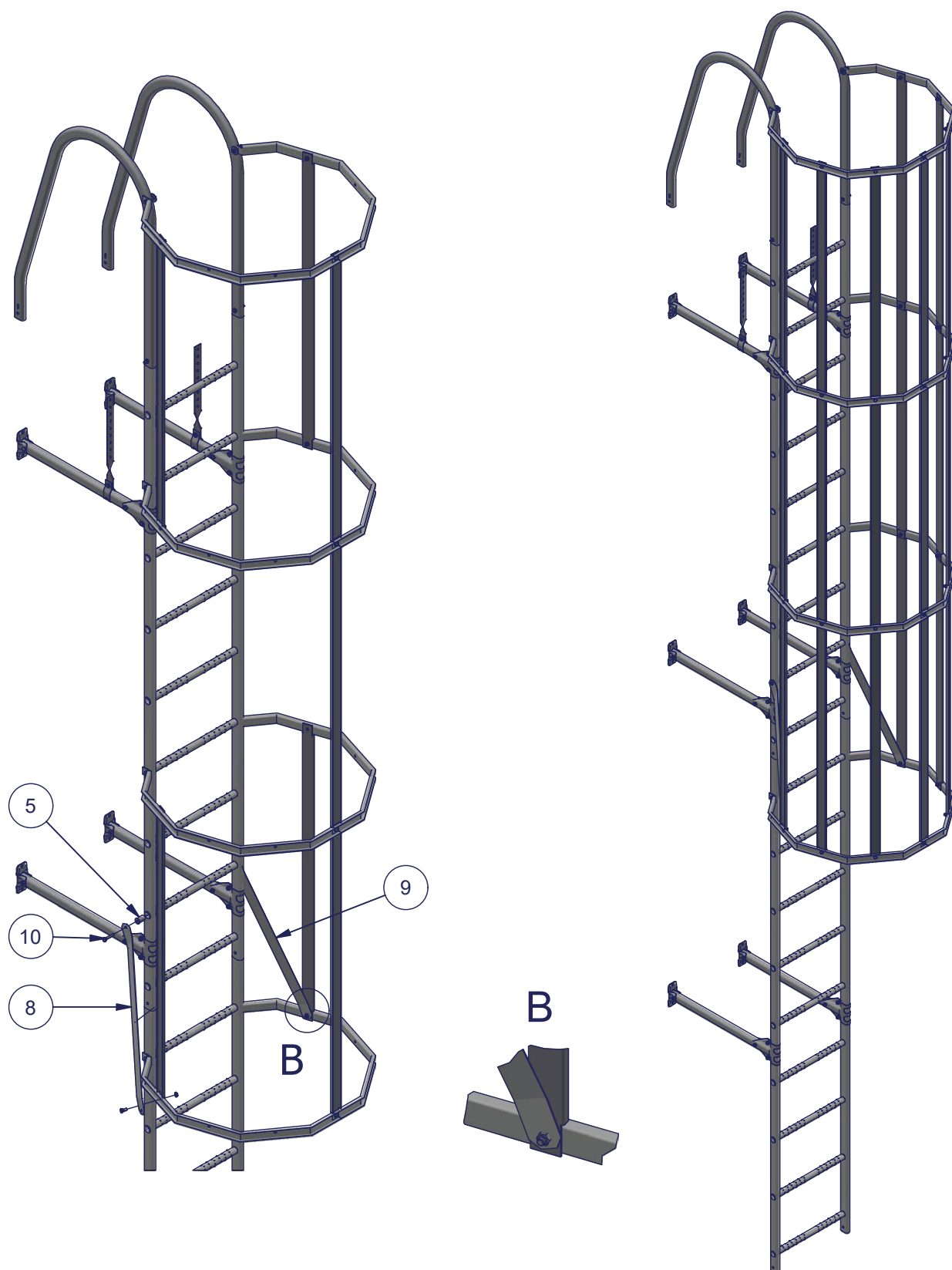

Assemble lowest rim pair vertical laths closest to the wall ladder from the lower end with M8x16 bolts and fasten left and right support lower end with the same bolts. Fasten left and right support upper end with rubber nuts and M8x60 bolts two rungs higher than lowest rim pair.

Install rest of the laths with M8x16 bolts and nuts.

INSTALLATION WITH WIDE BOWS



| Part | Description |
|------|---------------------------|
| 1 | Hexagon bolt M8x40, HDG |
| 2 | Hexagon nut M8, HDG |
| 3 | Hexagon bolt M8x16, HDG |
| 4 | Safety cage rim wide bows |
| 5 | Safety cage rim two-part |
| 6 | Vertical lath 1200 mm |
| 7 | Rubber nut M8x30 |
| 8 | Safety cage support left |
| 9 | Safety cage support right |
| 10 | Washer 30mm |
| 11 | Hexagon bolt M8x60, HDG |

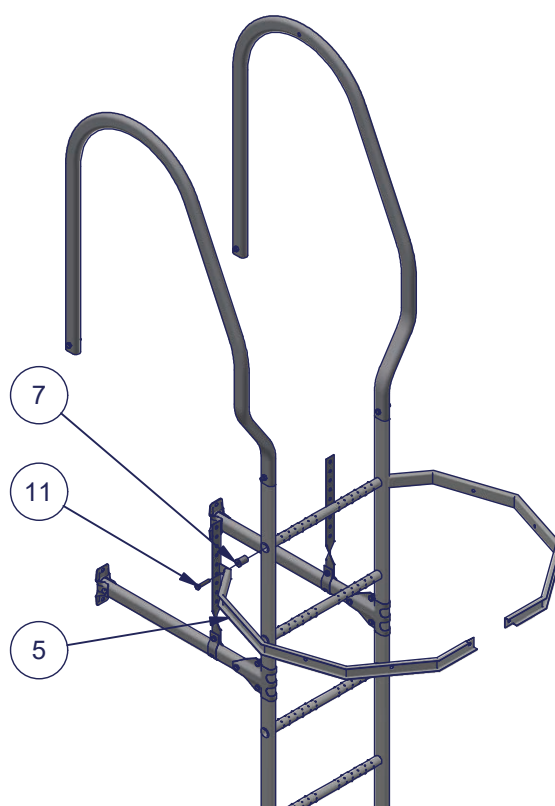

Before installing safety cage wall ladder are assembled according to wall ladder installation instruction.

Assemble pair of rims to wall ladders highest rung. Push rubber nut inside the rung so that nut shoulder stays against the rung. Set M8x60 bolt through the rim to rubber nut and tighten up with impact wrench so that rubber nut sticks well inside the rung. Do not overtight or the bolt will pull the rubber nut out.

Note! Assembling can also be started from below. In this case it is important to carefully calculate right starting point. Rim pair is assembled to every fourth rung (every 1200 mm). Starting from highest rung lowest rim pair level can be calculated depending on the height of the safety cage.

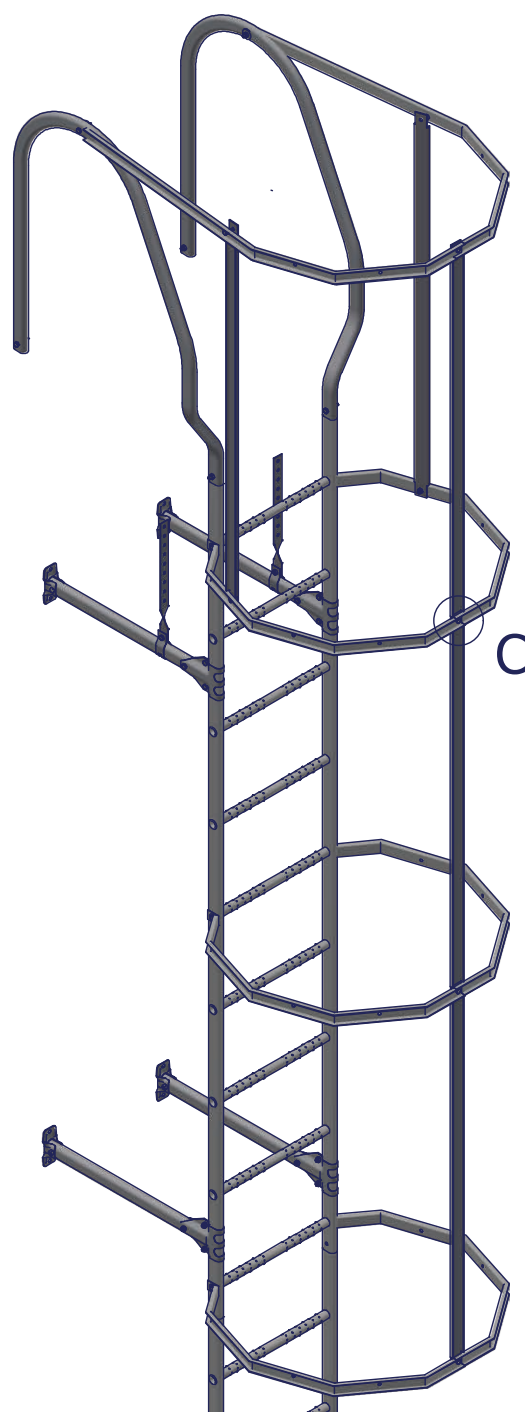
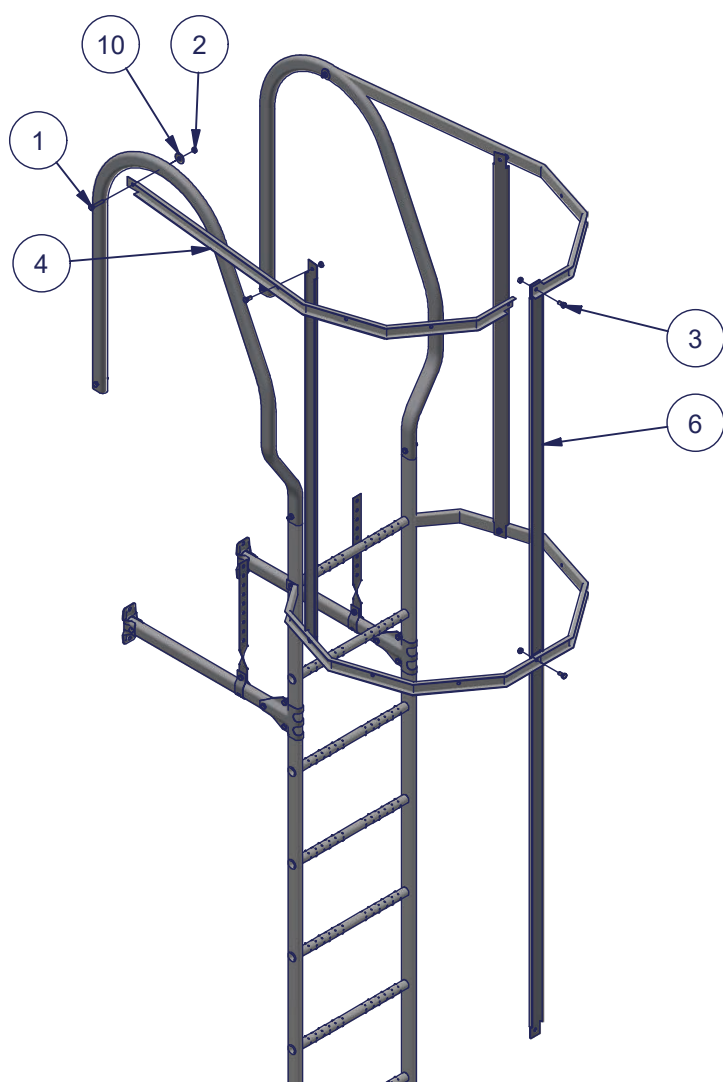

Fasten center line vertical lath pair through the rims with M8x16 bolt and nut.

Fasten top rim pair through vertical lath with M8x16 bolt and nut. After that fasten vertical lathes closest to the ladder between the rim pairs so that rims are installed parallel.

Check that rims are perpendicularly to the ladder. Drill holes through the bows and fasten top rims with M8x40 bolts. Assemble 30 mm washers with M8 nuts.

Install required number of rim pairs and centerline vertical laths every 1200 mm. Make sure, that every rim pair is fastened to wall ladder and to centerline vertical laths.

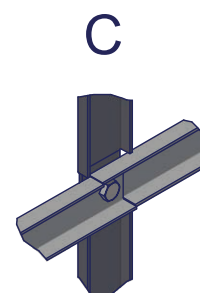

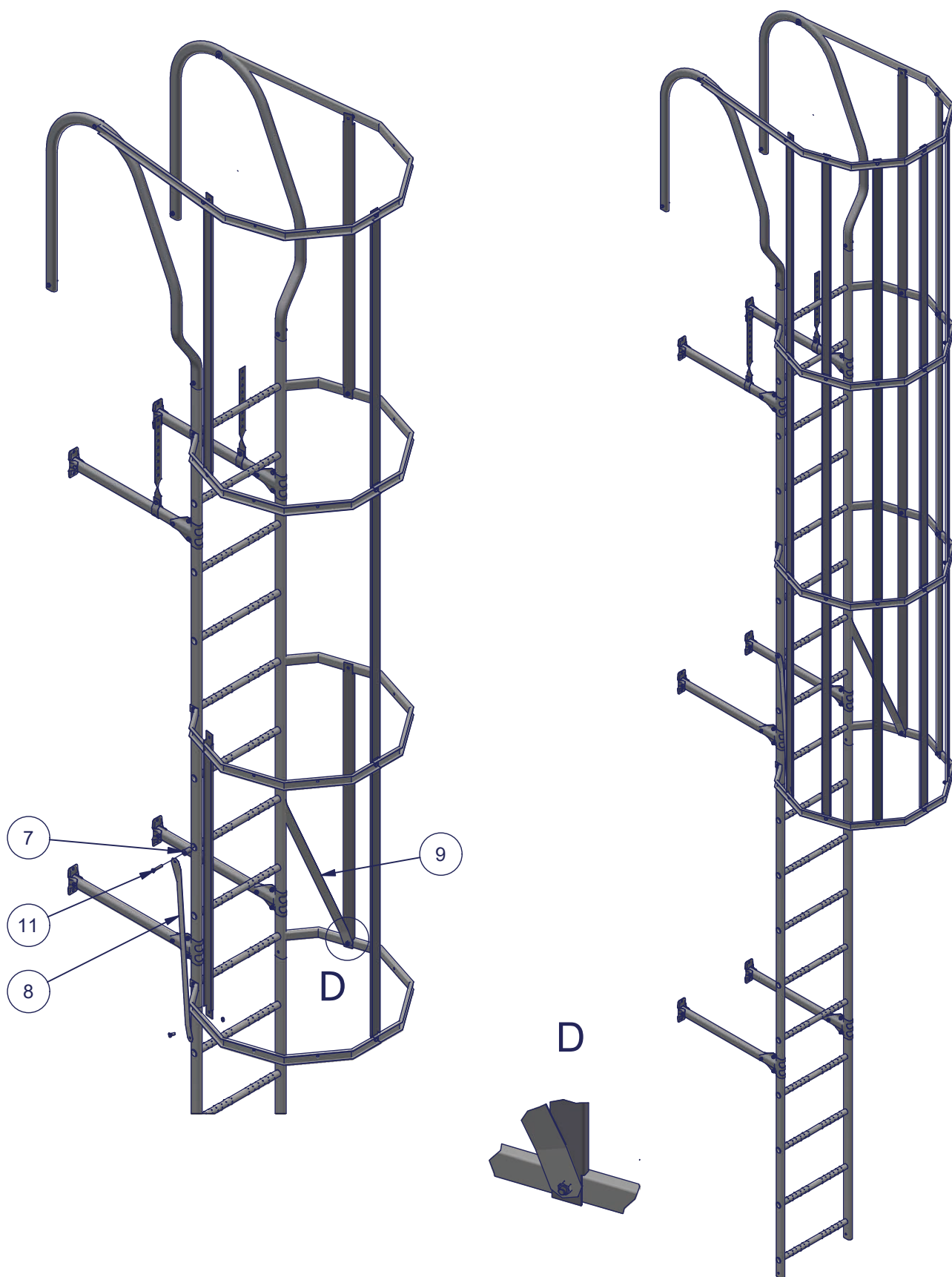

Assemble lowest rim pair vertical laths closest to the wall ladder from the lower end with M8x16 bolts and fasten left and right support lower end with the same bolts. Fasten left and right support upper end with rubber nuts and M8x60 bolts two rungs higher than lowest rim pair.

Install rest of the laths with M8x16 bolts and nuts.

USE

- Use only original parts provided by Piristee Oy. Safety cage is meant to be assembled with Pisko wall ladder.
- Pisko ladder safety cage is a system for light leaning and against swaying.
- Safety cage must not be used as a safety rope anchoring point!
- System may not be used if any damage is detected.

MAINTENANCE

As long as the Pisko products are installed in accordance with the instructions, they have a long life cycle and they are safe to use, guaranteed by the continuous quality control and R&D by Piristee Oy. In order to ensure the safe use and the long life cycle, the property owner must perform the annual inspection and maintenance procedures and ensure that the snow load is not exceeded, as specified in the regulations.

- Check the tightness of the joints and points of attachment.
- Remove the excessive snow load in order to minimize the stress on structures and points of attachment (as necessary, several times during winter).
- Check the painted and galvanized product surfaces and, as necessary, repair local damages and perform touch-up painting.
- Replace or repair any damaged or faulty parts as soon as possible.