

Safety railing for roof ladder

Part	Description
1	Ladder
2	Snow guard pipe (handrail) 3000 mm
3	Handrail collet
4	Crossing collet
5	Ladder fastening collet
6	Vertical bar for roof ladder
7	Vertical bar for roof ladder, crimped
8	Vertical bar

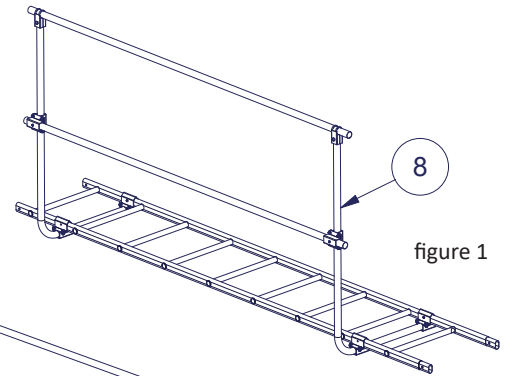

figure 1

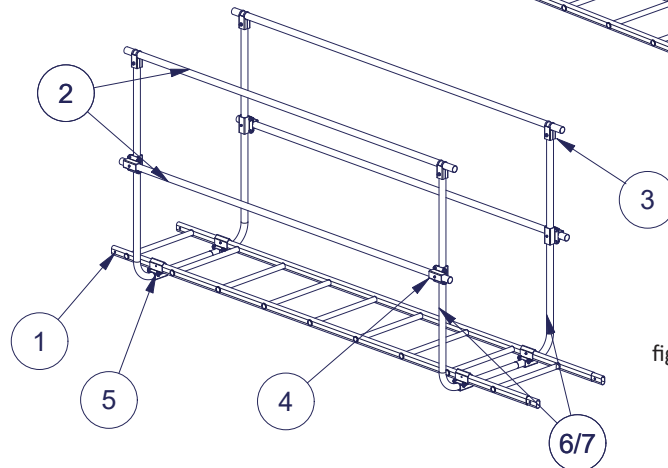

figure 2

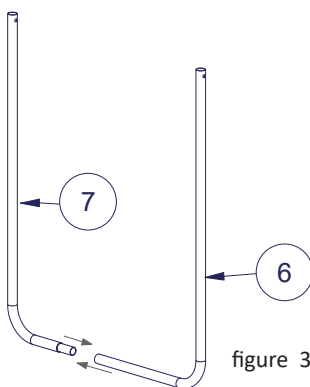

figure 3

1. The safety railing can be installed either on one or two sides (pictures 1 and 2). When installing safety railing the double-sided, the vertical bars are pressed tightly together and the connection is secured with a self-drilling screw if necessary (picture 3).

2. Attach the vertical bars to roof ladder with crossing collet and ladder fastening collet by using four bolts M8x16 and nuts M8 (figure 4).

The maximum permissible installation distance for the vertical bars is 2000 mm.

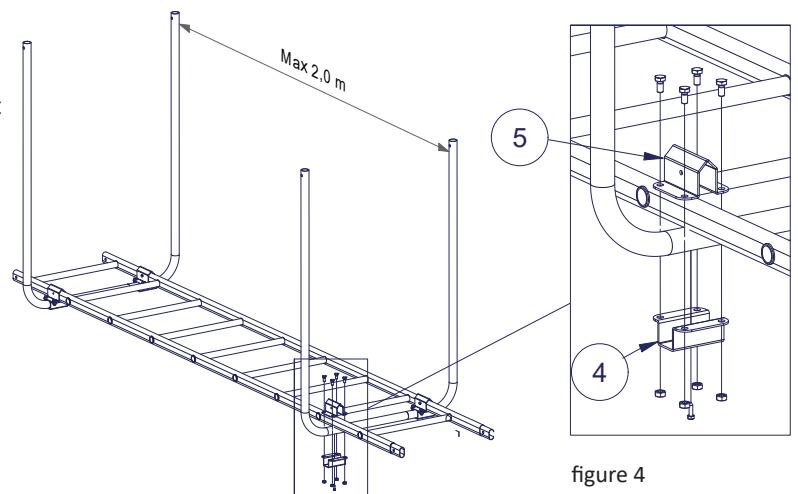

figure 4

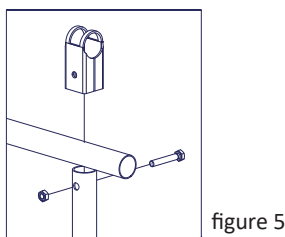

figure 5

3. Attach the handrail to the vertical bar with handrail collets by using bolt M8x50 and nut M8 (figure 5) and the lower handrail to the vertical bar with crossing collets by using four bolts M8x16 and nuts M8 (figure 6). Secure the attachment of crossing collet with self-drilling screws.

4. The extensions of the snow guard pipes (handrail) shall be done by sliding the pipe end with solid reducer inside the adjacent non-reduced pipe (figure 7). If necessary, secure connection with a self-drilling screws.

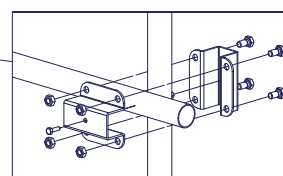
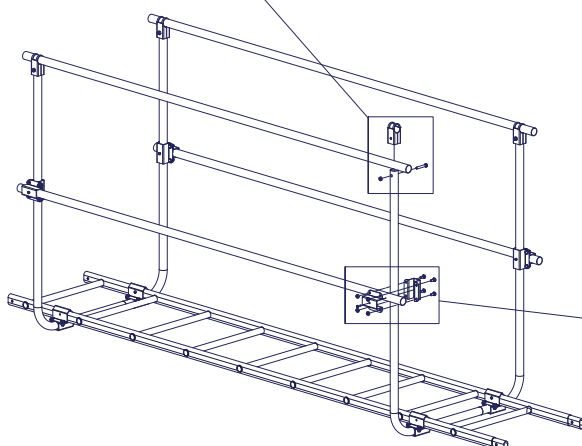

figure 6

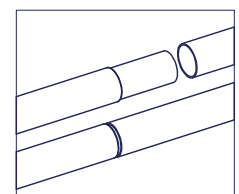

figure 7

MAINTENANCE

Pisko products are hard-wearing and safe to use, guaranteed by the ongoing quality control and development work by Piristee Ltd, as well as correct installation of the products according to the manufacturer's instructions. To ensure the reliability and safety of the products, the property owner must carry out yearly inspection and maintenance procedures and monitor that the installed products and the substructure (roof surface) surrounding the products are in good condition.

Check the tightness of joints, connections, fixings and attached devices.

Check the roof attachments (fixings). Ensure any excessive snow load is cleared to minimize the strain on structures, fixed devices and attachment points (as necessary; there might be a need to do this several times during the winter).

As necessary, clear the attached devices of snow and ice. Check the paintwork and metal coating of the Pisko-products; repair faults and touch up paintwork if necessary. Replace or repair any damaged or faulty parts as soon as possible to avoid any hazards.